



zalmandn

NBA-750A/750B Owners Manual



Contact us **00-82-31-222-2737**

We will try our best to help you about concerned contents if you inform us of model name and your contacting point.



Manufacturer/Seller :
Nano Biorhys @The company which take good care of air is the very **Nano Biorhys**



Strong Point of Product

Air Cleaner, Please check CADR.

When you select best product among many kinds of Air cleaner in shop, it is very difficult for you to select best Air cleaner. It is very important that you are kindly requested to select Air cleaner which can purify dirty air more cleanly and promptly. Please check CADR when you select best Air cleaner.

What is CADR ?

It means that delivery rate of clean air by a simplified character of "Clean Air Delivery Rate", indicate as amount of Air which is purified as much as 100% cleanly by Air Cleaner as manufactured by AHAM (The Association of Home appliance Manufacturers)

- CADR is a sole indicator which measure amount, level of air purification.
- The bigger figure of CADR, the more purify pollutants promptly. On the contrary, The smaller figure of CADR, the less purify pollutants. Accordingly, It takes a long time to purify inner air and filtering ability is fallen.
- CADR is evaluated by elimination efficiency of "Tobacco smoke, dust, pollen" by operating of Air cleaner in experimental chamber.

- Dust : 10-400 CADR
- Tobacco smoke : 10-450 CADR
- Pollen : 25-450 CADR

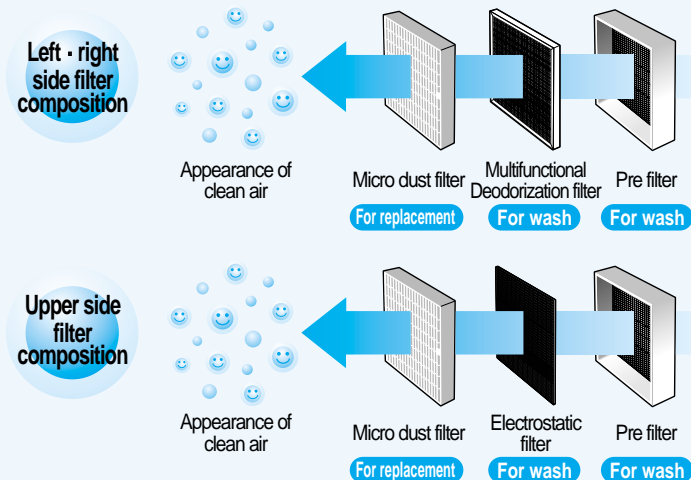

※ Electrostatic filter of upper side is a option and it can be changed according to choice of Consumers.

Characteristics of Product

1. Maximization of filter size and Superiority of Collection Efficiency

Purification ability of filter was maximized by adopting filters of 3 stages (Pre filter, Multifunctional Deodorization filter, Micro dust filter) through upper, Left and Right's side. These 3 stage filter trap micro dust over 99.97% of 0.3 micro meter granule, tobacco smoke, VOCs (Volatile Organic Compounds), odor materials.



2. Realization of performance of the top in the world through strong purification ability

The air purification ability (CADR) of the top in the world was realized more than 450 through inhale of polluted air by 5 sides and exhaust of purified air by 3 sides.

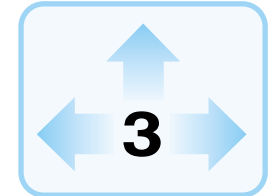

3. Objective Alarm function of Blocking degree, Replacement time at the first in the World

The blockade of micro dust filter is checked and indicated through measurement of pollution degree by pressure sensor (Patent No.10-2004-0076168 , Utility Registration No.0329577)

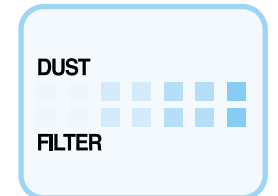

4. Direct control by consumers by adopting Checking button of filter (at the first in the World)

The purity efficiency of Inner area can be maximized by informing blockade degree, replacing time of filter to consumers objectively

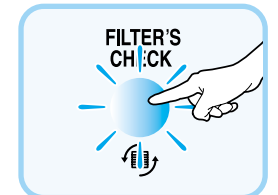

5. Indicator through Emoticon

The operating situation of Air cleaner from a far distance can be checked through a varied kinds of Emoticon

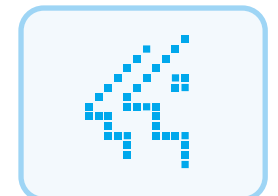

Strong Point of Product

Characteristics of Product

6. The measurement of Inner pollution level

The pollution level is checked with the naked eye through dust sensor and is automatically operated with optimum mode.

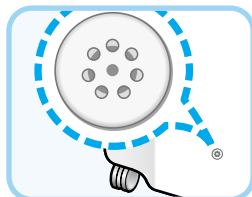

7. Appearance of minus Ion

The purity air is preserved through appearance of minus ion from a terminal of minus ion of upper side together with clean air.

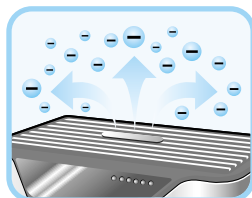

8. Emission of Aroma

Aroma from upper side is emitted according to taste of consumers and the amount of emission can be controlled.

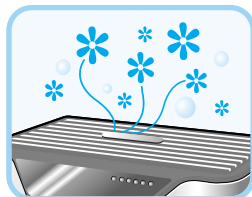

9. Re-using of filter

Pre filter can use continually cleanly because is designed so that water wash may be available and consumer is revived filter Performance equally with first briefly. Multi-function deodorization filter can do to maintain deodorization function of early state if wash in flowing water by once at 2 months using water carbon filter.

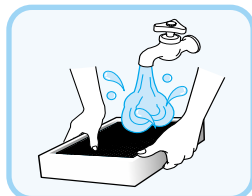

10. Convenience of moving

Through using of caster can be freely moved room to room, room to floor.

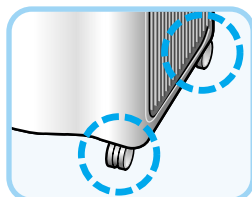

Table of Contents

Preparations for using

Precautions in Safety	5
Indicators for each category	13
Air circulation channel	14
Name and resolution of Filters	15
Separation method of filter's box	16
Name of each category	17

Basic Contents

Instructions before using	21
Auto operation	22
Manual operation	23

Practical Contents

Control of Cleanness degree	25
Peservation operation	26
Inspection Function of Filter	27
Control method of Intensity of Pollutants's sensor	28

Others

Life's Wisdom	29
Cleaning and Maintenance	30
Check points before reporting of trouble shooting	32
Specifications	34

Precautions in Safety



Installation

Prohibition Please do not install product at the place where gas is leaked.
■ It may cause explosion or fire.

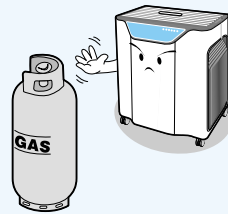

Precaution Please do not install at the place where industrial oil smoke and metallic dust are occurred.
■ It may cause trouble, fire.



Prohibition Please install the product after avoiding direct light, heating appliances, especially moisture.
■ Performance of product is fallen and it may malfunction.

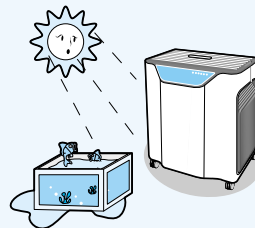

Warning Please use product rightly after reading contents well for safety of users.

Power Supply

Prohibition Please do not unplug a electric wire and touch plug by wet hands.
■ It may cause electric shock and fire.



Prohibition Please do not twist a electric wire and overpower in heavy things.
■ It may cause electric shock and fire

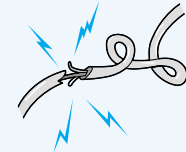

Prohibition Please do not use injured power cord, plug, loose-fitting outlet.
■ It may cause electric shock and fire.

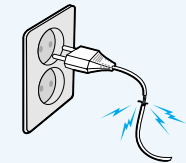

Prohibition Please do not use over-loaded outlet with several cordsets simultaneously.
■ It may cause electric shock and fire.

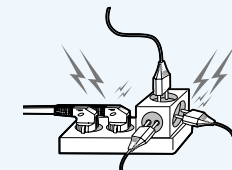

Precautions in Safety



Warning

During using

Prohibition Please do not sprinkle combustible spray and insert powder on product.
 ■ It may cause malfunction and electric shock, fire.



Prohibition Please insert a finger, other materials in inlet or outlet on product.
 ■ It may cause malfunction and electric shock, fire.



Precaution Please do not go up on product and touch product without permission for children.
 ■ It may cause malfunction, accidents.



Prohibition of Disassemble Please do not resolve and repair, reconstruct a product.
 ■ It may cause malfunction and electric shock, fire. please contact a service center if product is needed to repair.



Precaution Please use product rightly after reading contents well for safety of users.

Installation

Prohibition Please do not install at the place where is not smoothed and inclined ground.
 ■ It may cause malfunction and strange noise.



Precaution Please install a product at the place where is far more than 30cm from nearby.
 ■ The purification ability may fall in case inhale area of air is narrowed from space.

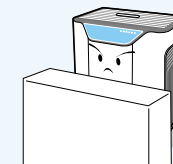

Precaution Please do not place an obstacle in inlet or outlet of product.
 ■ It may cause malfunction and air purification efficiency may fall.

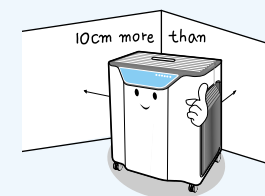

Precautions in Safety



Precaution

Power Supply

Prohibition Please do not put off air cleaner through power supply plug.
 ■ It may cause malfunction, electric shock and you are kindly requested to put off power supply through power-button.



Precaution Please contact a service center after putting off a power supply In case strange noise and burning smell, smoke may caused from product.
 ■ It may cause electric shock, fire seriously.



Precaution Please contact a agent or service center if you need to repair the product.
 ■ It may cause a electric shock or fire in case it is resolved, repaired.



Precaution Please unplug if you do not use for a long time.
 ■ The un-needed electric power is exhausted and may cause a short circuit, fire.

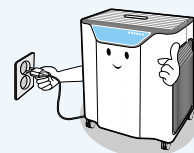

Precaution Please use product rightly after reading contents well for safety of users.

During using

Prohibition Please do not open filter box during operation.
 ■ The operation will be stopped in case the filter box is opened.
 ■ Please re-operate after putting the power supply's button after closing the filter box.

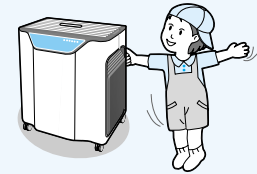

Prohibition Please do not operate for the purpose of using of ventilation fan, Range hood.
 ■ The life of product will be possibly shortened.

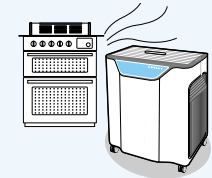

Precaution Please be sure not to insert the water inside product.
 ■ It may cause electric shock, fire.



Prohibition Please do not give over-loaded impact on product artificially.
 ■ It may cause malfunction, fire.

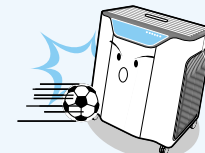

Precautions in Safety



Precaution

During using

Prohibition Please do not place cups including water on product.
 ■ It may cause electric shock, malfunction.



Prohibition Please be sure to ventilate occasionally in case it is used together with combustion appliances in closing inner area.

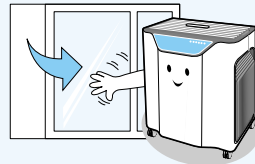

Precaution Please use after inserting filter essentially.
 ■ The purification ability will be fallen if it is operated without filter.

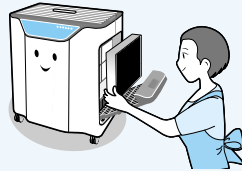

Precaution Please contact a service center in case product is flooded without fail.
 ■ It may cause electric shock, fire.

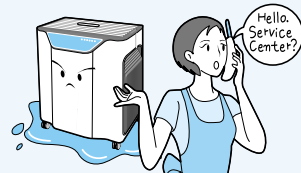

Precaution Please use product rightly after reading contents well for safety of users.

Others

Precaution Please be sure not touch direct light in case filter is dried after washing.
 ■ The filter has a possibility of transformation.
 ■ Please use filter after drying 12 hours in shade.

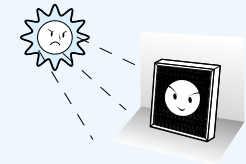

Prohibition Please start a cleaning, repair In case a power supply is putted off and turning of fan is stopped.
 ■ It may cause electric shock, other danger.

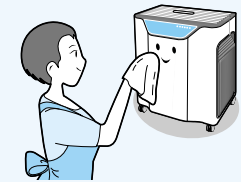

Precaution Please do not clean through using of chemicals, Alcohols etc.
 ■ It may cause electric shock, fire.
 ■ The out side of product can be transformed.



Precaution If filter replace emoticon is registered or 5 steps (red color) pilot light twinkles, change filter



Indicator of each category

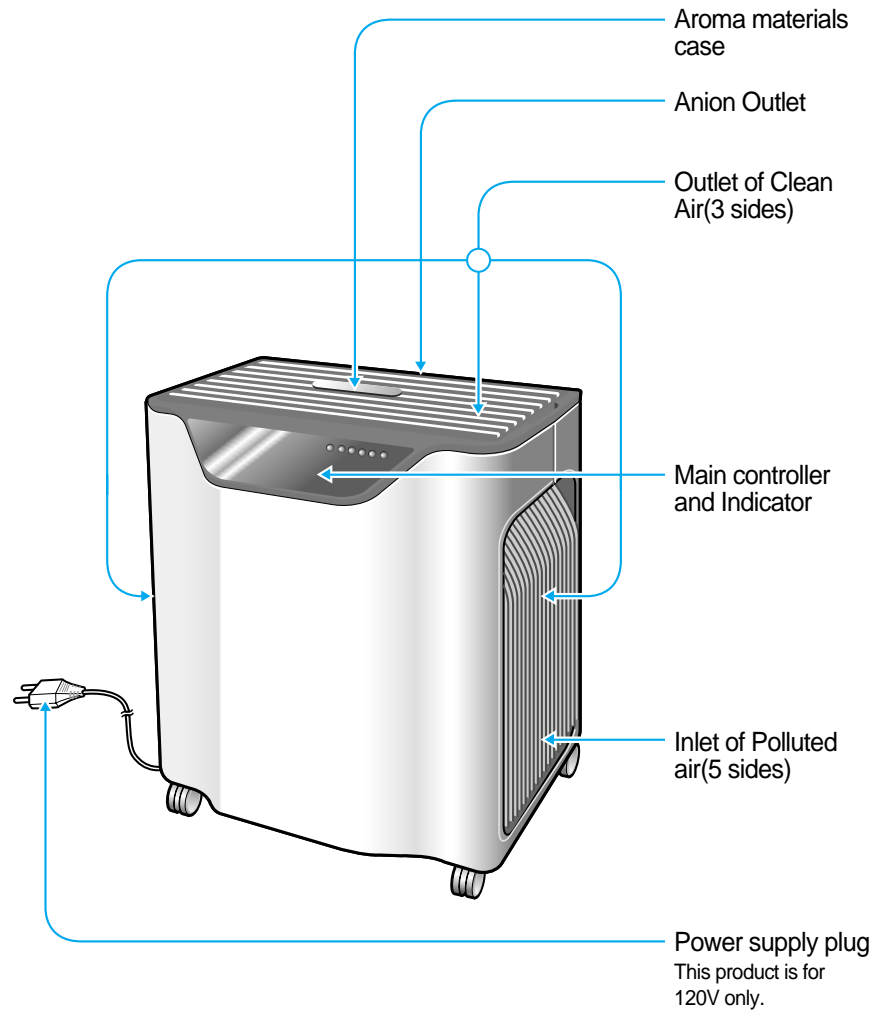

Air Circulation Channel

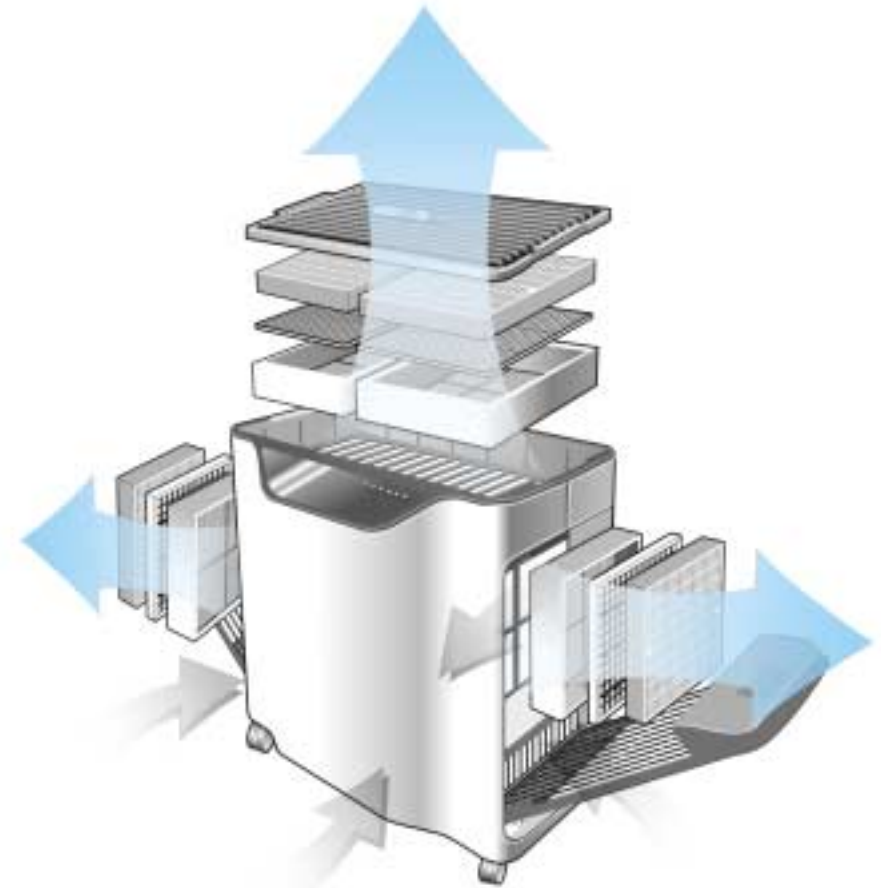

Name and resolution of filter

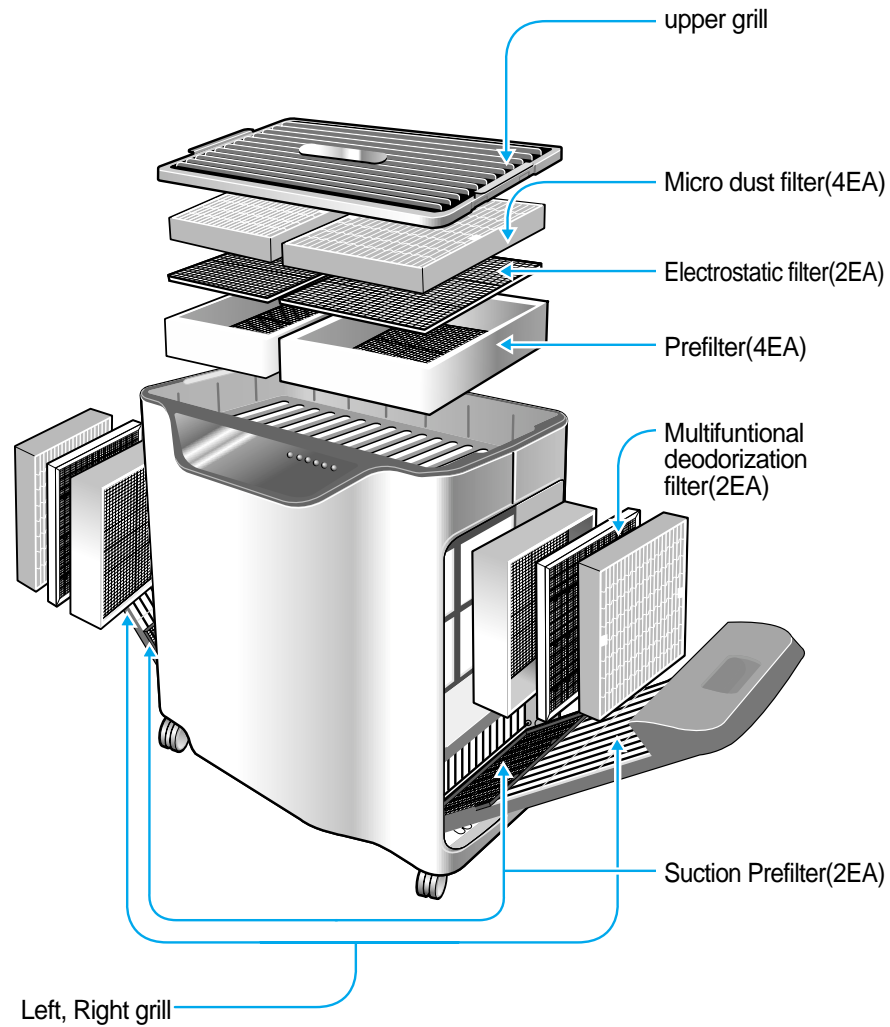

Separation method of Filter's Box

How to separate upper-filter.

Please draw up upper grill through a handle and take out inner filter box and then separate each filter.

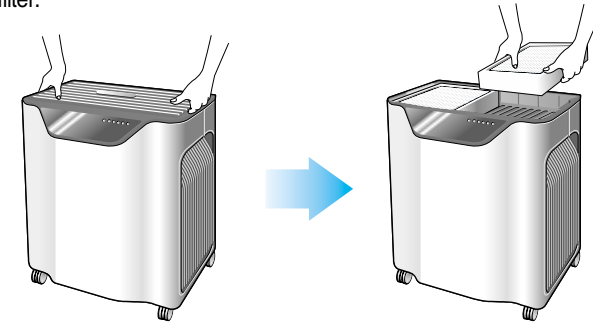

How to separate filter of left, right side.

Please open filter box to the body side after grasping grill handle of left, right side and then take out inner filter box and separate each filter.

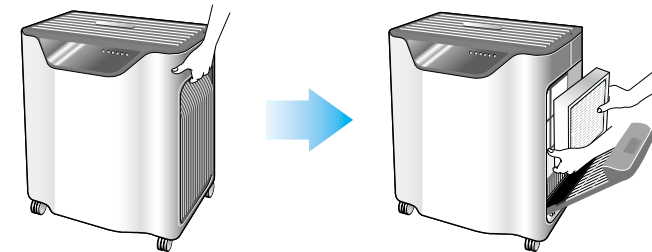

Indication of pollution level (Dust, Dust condition) ※ () 750A product

NBA-750A

DUST



FILTER

NBA-750B



- It is indicated as 4th stages of pollution level as large dust and small dust per smell.
- Inner air is good in case of green color and is normal in case of yellow color, is bad in case of red color.

Name of each part

Main controller and Indicator (NBA-750A)

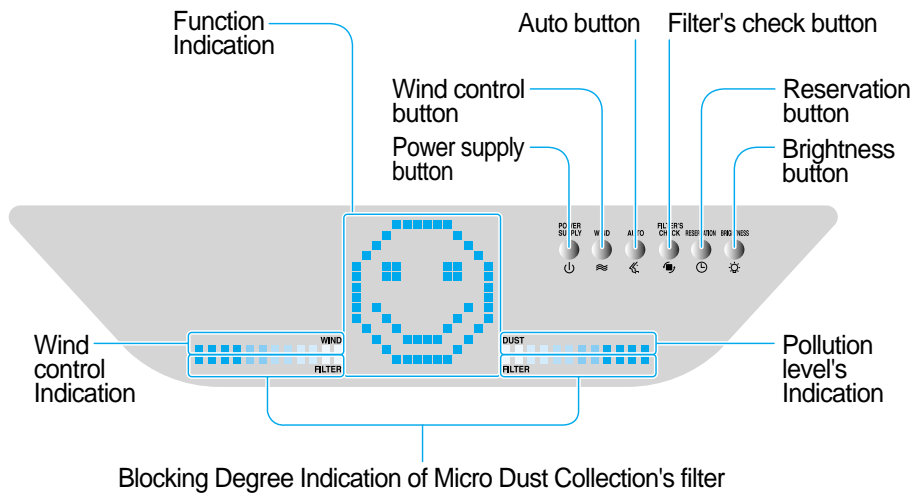

	Inner situation is good		Filter exchange		Reservation for 1hr
	Inner situation is normal		Uninstallation during reservation time		Reservation for 2hr
	Inner situation is bad		Wind Level 1		Reservation for 3hr
	Auto function		Wind Level 2		Reservation for 4hr
	Night operation		Wind Level 3		Reservation for 5hr
	Repair is needed		Wind Level 4		Reservation for 6hr
	Filter's checking		Turbo Mode		Reservation for 7hr
					Reservation for 8hr

Button explanation

- POWER SUPPLY**
In case power supply is on, operation is started from auto-operation mode and in case push the button again is off.
- WIND**
Wind is controlled from 1st stage to Turbo mode (5th stages) and you can select wind level according to space.
- AUTO**
The pollution level of inner air is automatically sensed by dust sensor in case auto level is selected through automatic control of fan.
- FILTER'S CHECK**
In case filter check button is operated, It is operated at 4th stage mode for 25 seconds and then filter situation is automatically sensed and indicated on board.
- RESERVATION**
The reservation button is operated , it is operated by fixing mode of reservation time and that time is fixed from 1hr to 8hr in case you push the button.
- BRIGHTNESS**
Brightness on Indicator can be controlled from 1st stage to 3rd stages according to consumer taste.

Reference In case of auto operation and surroundings are dark, silence operation is started by 1st stage and auto operation is started again in case surroundings are bright.

Name of each part

Main controller and Indicator (NBA-750B)

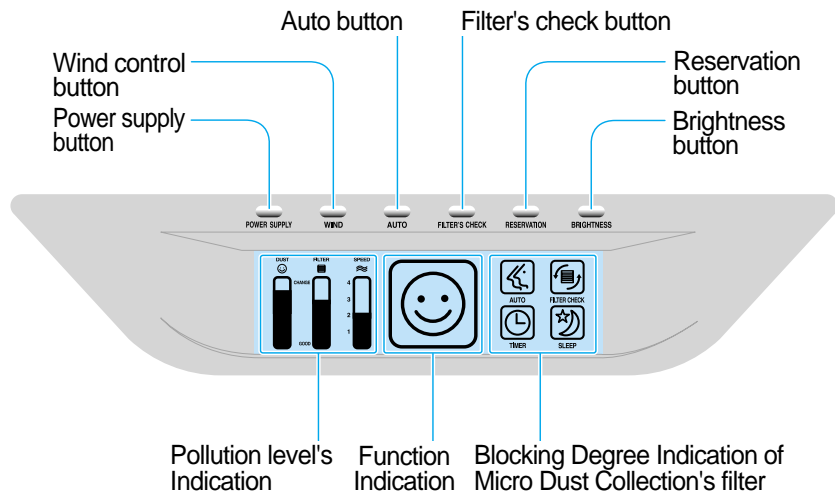

	Inner situation is good		Filter exchange		Reservation for 1hr
	Inner situation is normal		Uninstallation during reservation time		Reservation for 2hr
	Inner situation is bad		Wind Level 1		Reservation for 3hr
	Auto function		Wind Level 2		Reservation for 4hr
	Night operation		Wind Level 3		Reservation for 5hr
	Repair is needed		Wind Level 4		Reservation for 6hr
	Filter's checking		Turbo Mode		Reservation for 7hr
					Reservation for 8hr

Button explanation



In case power supply is on, operation is started from auto-operation mode and in case push the button again is off.



Wind is controlled from 1st stage to Turbo mode (5th stages) and you can select wind level according to space.

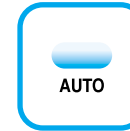

The pollution level of inner air is automatically sensed by dust sensor in case auto level is selected through automatic control of fan.



In case filter check button is operated, It is operated at 4th stage mode for 25 seconds and then filter situation is automatically sensed and indicated on board.



The reservation button is operated, it is operated by fixing mode of reservation time and that time is fixed from 1hr to 8hr in case you push the button.



Brightness on Indicator can be controlled from 1st stage to 3rd stages according to consumer taste.



In case of auto operation and surroundings are dark, silence operation is started by 1st stage and auto operation is started again in case surroundings are bright.

Name of each part

Remote Control

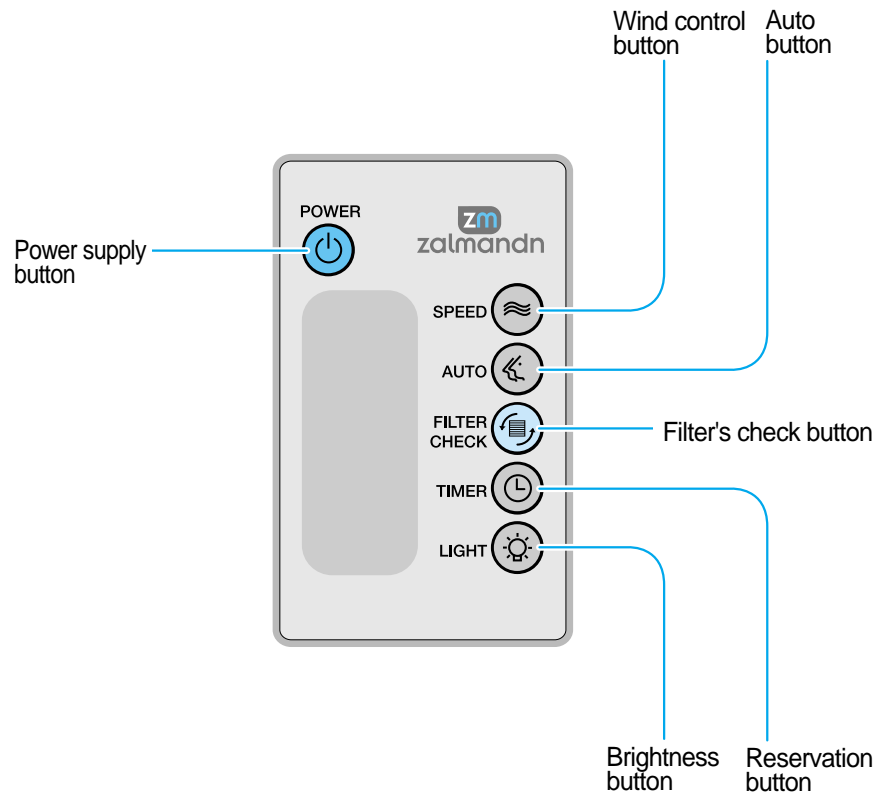

Check point before using

Please check the following contents before using in advance and then you can use air cleaner effectively.

Installation

Please check the following installation condition for your satisfaction.

- Flat place where is not inclined.
- The place where has not interrupted inlet and outlet of Air.
- The place where has not moisture and inflammable.
- The place where is not interrupted for passing.
- The near place from outlet.



The power supply plug and outlet

Please plug with outlet of 120V only for power supply.

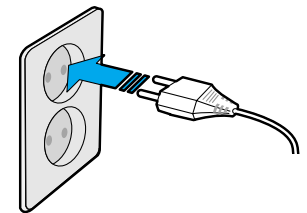

Auto operation

You can control purification level according to pollution situation of inner air.

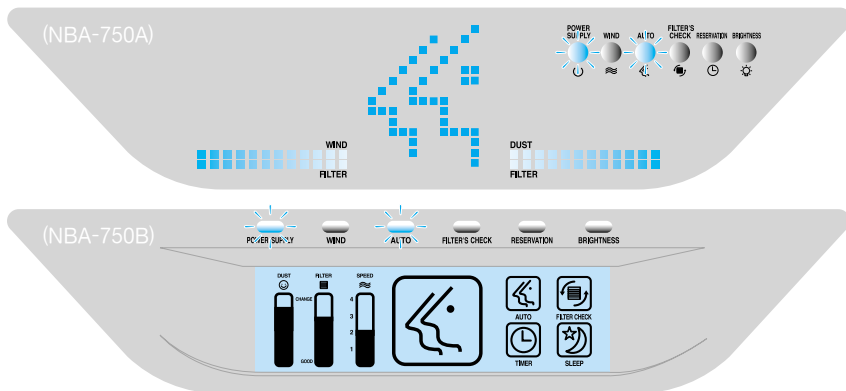

In case air cleaner is not operated,

please push button and operate.
 ■ The sound is changed and then auto operation is started.



In case air cleaner is operated,

Please push button and select Auto button.
 ■ The repeated operation of Auto and Manual is selected whenever push the button.
 Please select and push button by the time of indication for Auto operation.



The operation condition in case of auto operation

Purification condition.
 ■ The optimum purification condition is selected according to Pollution level of inner air and then need not to control separately.
 ■ In case you control purification condition, Auto operation is cancelled and is operated according to selected purification condition.



Anion
 ■ The appearance function of Minus Ion is automatically selected and need not to push button additionally.

Manual Operation

We want to remove dust which was entered into indoors.

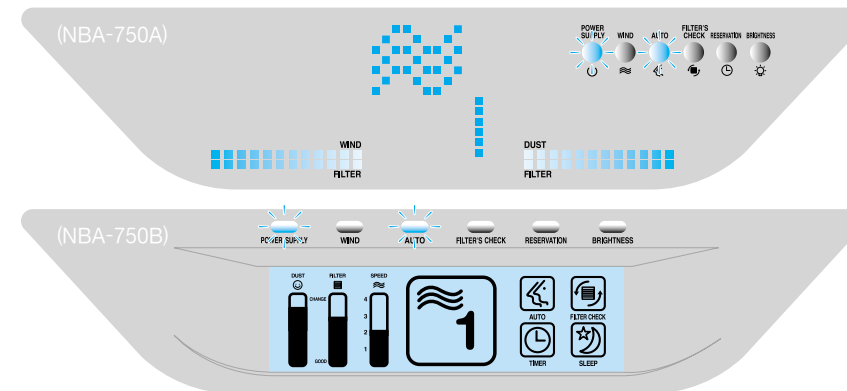

Please push button and operate.

■ The sound is changed and Auto operation is started.



Please push button and select Manual operation

■ The repeated operation of Auto and Manual is selected whenever push the button.
 Please select and push button by the time of indication for Manual operation.

The operation condition in case of Manual operation

Purification condition.
 ■ You can control purification condition directly . In case you control auto operation, manual operation is cancelled and is automatically operated according to pollution degree.

Control of Purification Condition

Want to regulate purification condition of cleanliness wind freely

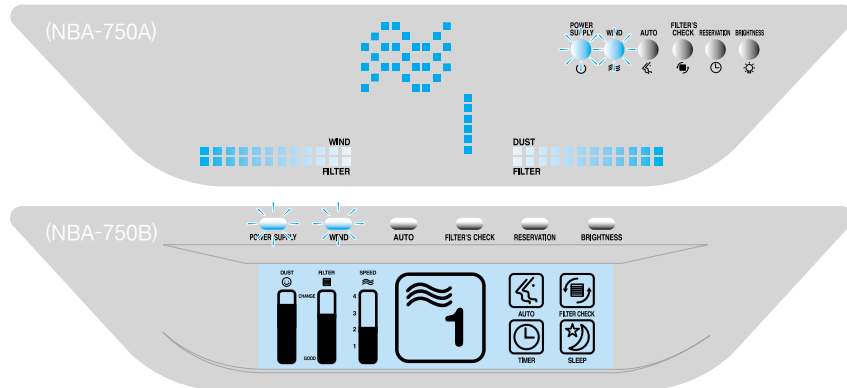

Control method of Purification Condition

- WIND** Please select your desired Purification condition after pushing the button.
- The repeated operation is selected from 1 to Turbo(5 stages) whenever you push the button.
- Please select and push the button by the time of indication for your desired purification condition.

The operation condition in case of control of purification condition

- Purification condition**
 - Operation is started by selected purification condition.
 - In case you push the Auto button, selected purification condition is cancelled and air cleaner is operated by Automatic condition.

Peservation Operation

We want to operate according to appointed time.

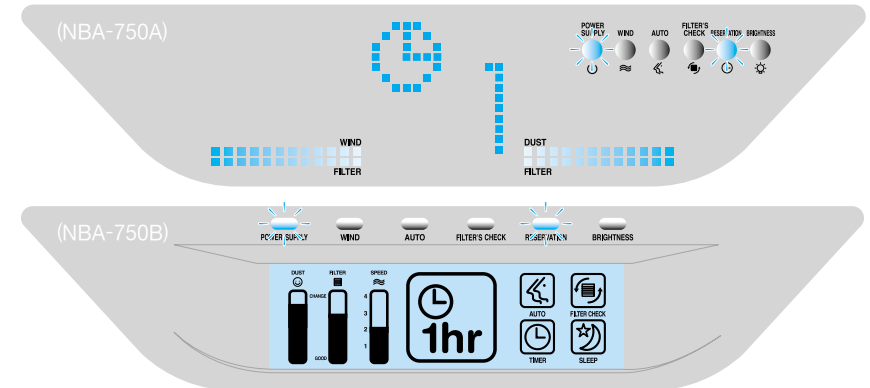

Please push the button and operation is started.

- The sound is changed and air cleaner is operated Auto operation is started.



Please push the button and select Reservation operation.

- The setting time of reservation is from 1hr to 8hr and reservation time is setted per 1hr. If you want to cancel the setting, the indication of " OFF " on board is appeared after pushing button repeatedly and then setting is cancelled.



Control of Brightness on Indicator

- Users can control Brightness by 3 stages under the condition of unburden to consumers.

Operation condition in case of Reservation operation

- Purification condition**
 - In case surroundings are dark, silence operation is started after 3 minutes as 1st stage automatically and surroundings are bright, Auto operation is started after 3 minutes.

Filter's check button

We want to know condition of Filter.

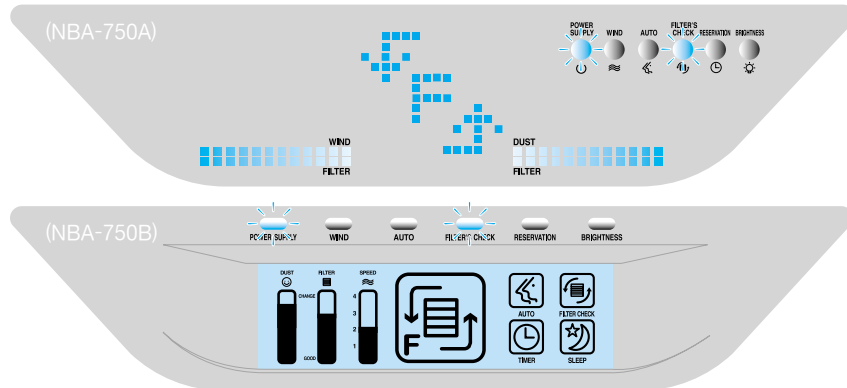

FILTER'S CHECK



Please select check of Filter after pushing filter's check button

- If you push button of Filter's check , filter condition is inspected for 25 seconds and then filter's condition is indicated on board.

Filter's Inspection

FILTER'S CHECK



Please push the button

- 1st stage(Green color) : The first condition of Filter
- 2nd stages(Yellow color) : The condition which life of filter was consumed about 40%
- 3rd stages(Yellow color) : The condition which life of filter was consumed about 60%
- 4rd stages(Yellow color) : The condition which life of filter was consumed about 80%
- 5th stages(Red color) : The condition which life of filter was ended at 100%.
The Alarm for replacement of Filter is indicated on Board.

Information



- In case of Auto operation, filter's condition is automatically inspected by Pollution sensor from 1st stage to 4th stages according to pollution degree and filter's condition is automatically indicated on Board.
- If filter exchange time arrives, inform 5 steps (red color) pilot light with many a wink repeatedly.

Control Method of Sensitivity through Perception Sensor of Pollution

Want to regulate sensitivity at dust sensor

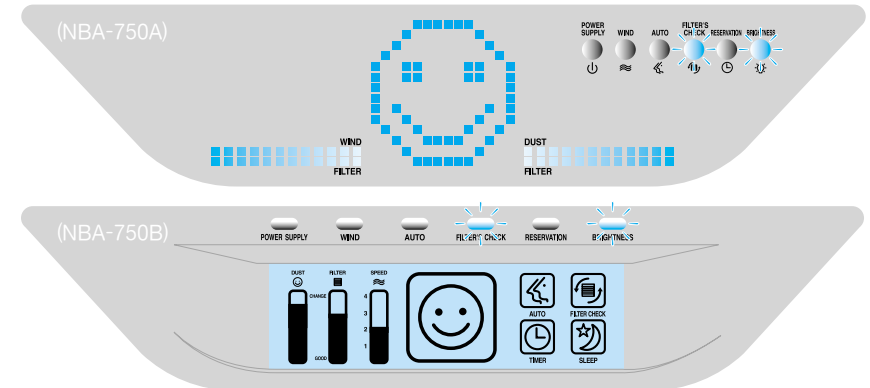

FILTER'S CHECK



BRIGHTNESS



Please select control mode of Perception through insepction button and Brightness button of Filter at the same time after pushing 3 seconds.

- Dust's indication is flicker together with clang after 3 seconds if you push the button of 2 types(Filter's inspection and Brightness) at the same time.
- If you push Filter's Insepction button , indication board is changed to Insepnsibility(Yellow) → Normal(Yellow) → Sensivity(Red).

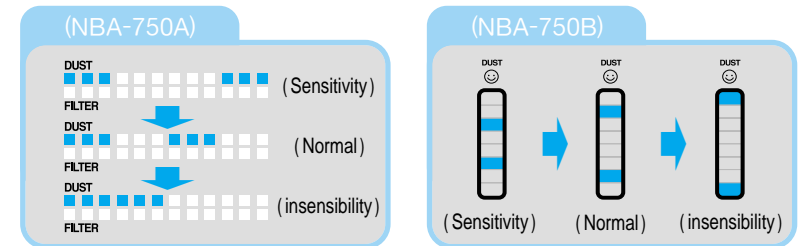

- Change of Perception control is ended after 3 seconds.

Information



- The normal Perception was setted in case of forwarding of product . You can control due to setting under the Sensivity in Clean area, under the Normal in Normal area and under insensitivity in Pollution area.

Life's Wisdom

Please kindly refer to following contents for energy saving.



Installation

Never place unit in direct sunlight and nearby heating appliances.

- Please draw curtain in case sunlight is shined through window.
- please do not locate heating appliances nearby air cleaner.
- Please do not locate inclined place.

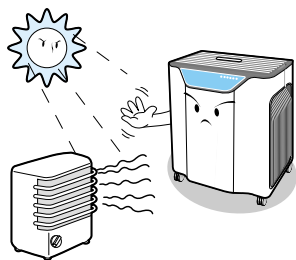

Operation

Please Close window ,door during operation, if possible

- The purification effect is fallen in case window and door are opened.

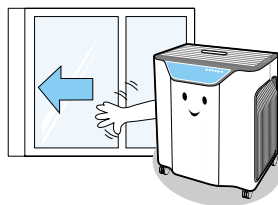

Others

Please use after fixing filter perfectly and wash frequently.

- It is not expected to get purification effect if you use filter under the condition of unfixing.
- The purification effect is fallen if filter is not clean. Accordingly, you are recommended to wash filter frequently in case Indicator of filter washing is on. Please frequently wash prefilter and Deodorization filter in case they are polluted.

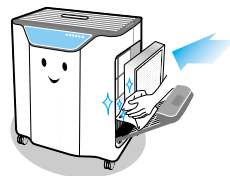

Cleaning and Maintenance

Please unplug if you want to clean air cleaner.



Cleaning Method of outside

Please wipe unit with a soft damp cloth.



- Please do not wipe with alkaline detergent in case of front controller and Indicator.
- Please do not wipe surface of unit do not put and sticker by using of sulfuric acid, hydrochloric acid etc. The surface of unit can be damaged.

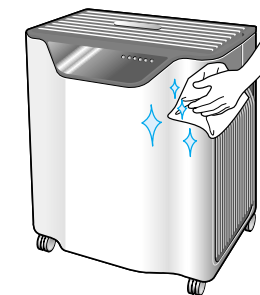

How to clean Dust sensor

The dust sensor is equipment which sensed pollution level of small, big dust and you are frequently required to clean lens of dust sensor to maintain performance.

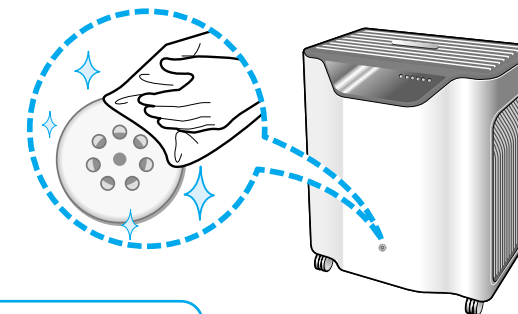

- Please frequently clean perception part of Dust under the condition of environment of much dust due to possibility of unperformance.

Cleaning and Maintenance

Please unplug in case of cleaning



How to wash filter

Filters has a function of elimination for minute dust and tobacco particle on air.
Please wash filters as the following method once every three months or Indication lamp on main controller is on.

- 1 Please pull filter box after opening grill of left, right side.
- 2 Please separate Micro dust Filter from Filter box after drawing handle.
- 3 Please wash Filter box(Prefilter) and Multifunctional Deodorization with tepid water.
 - Prefilter wipes soft solo net in lukewarm water that dilute neutral detergent in case pollution is serious.
 - In the case of multi-function deodorization filter, wash in flowing water by once at 2 months. Can improve deodorization efficiency.

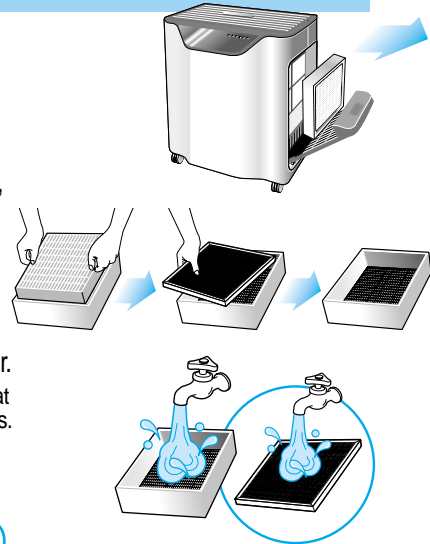

■ Micro dust Filter can not be washed by water.

- 4 Please insert again after drying perfectly for more than 5 hrs in case of Multifunctional Deodorization
 - filter after washing. Please escape direct lighting during drying otherwise, filter has a possibility of transformation.
- 5 Please insert filter box and push button of Filter's inspection.
Please press button for filter examination.
 - Unit is operated at 4th stage about 25seconds and filter condition is automatically indicated on board.
- 6 Please replace filter in case of informing of replacement on Indicator.
 - Please use unit after pushing button of filter's inspection , replacing collection filter only.

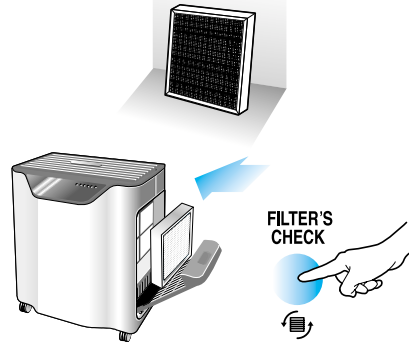

■ A period of washing on filter can be changed according to using envimment.

Check points before reporting of trouble shooting

Please check before reporting of trouble shooting



Symptoms	Check points	Solutions
Unit does not work 	Is there a stoppage of electric current?	Please check connection of electric current and operate again.
	Is power supply plug not connected?	Please set power supply plug and operate again.
	Does outlet not good?	Please opereate with other outlet again?
The strange smell is come out	Do you use unit at the place where is come out a strange smell and smoke?	It is possibility to fall air purity effect at the place where is come out a strange smell of smoke so much. Please use air cleaner after ventilating a inner air.
	Is wash filter not clean?	Please wipe wash filter cleanly.

Check points before reporting of trouble shooting

Please check before reporting of trouble shooting



Symptoms	Check points	Solutions
The lighting of Indicator is not clear.	Is brightness condition not controlled at 3 stages ?	Please control stage of brightness after pushing button of brightness.
The operation condition is not so good In spite Inner air is impure.	Does lens of dust sensor not clean?	Please clean lens of dust sensor.
	Does wash filter not clear?	Please clean wash filter.
The Indication lighting for alarm of filter replacement is on continuously	Is not filter state indication candlepin room region lighted up to end in whole surface indication department?	Exchange new filter or clean washing filter

Specifications

Model Name	NBA-750A / NBA-750B
Power Rating	AC 120V / 60Hz
Service Area	698 FT ²
Power consumption	67 W
Operation electric current	0.5 A
Weight	14 kg
Dimension	W 530 × D 360 × H 670 (mm)

• Design and Specifications are subject to change without information for upgrade of quality.

